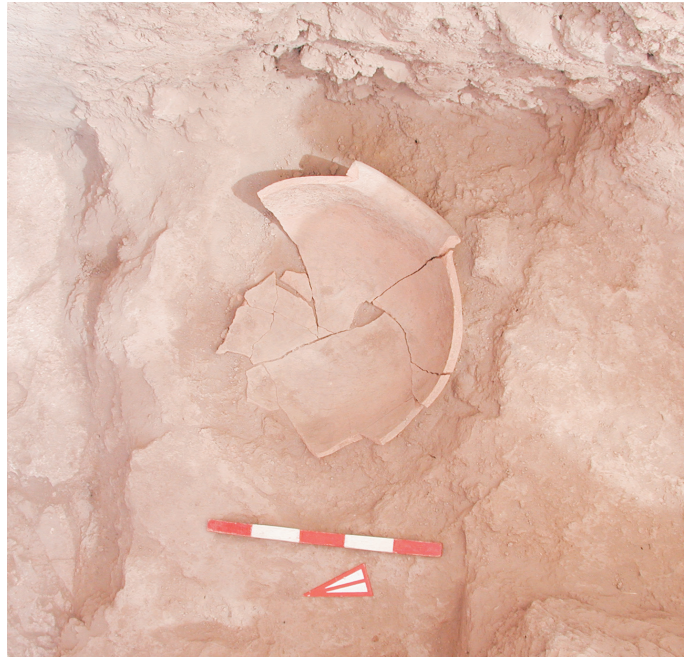

Photo V14d4210 F. Buccellati



Illustr. 10:1 Jar A16.68  
(Burial A16a15) before removal

Photo V14d4214 F. Buccellati



Illustr. 10:3 Jar A16.68  
after partial removal

Photo V14d7586 F. Buccellati



Illustr. 10:2 Jar A16.68 during restoration  
(S. Bonetti and Stef Mustafa)  
with digital photo of full jar (V14d4210)  
shown above as Illustr. 10:1

Photo V14d7585 F. Buccellati



Illustr. 10:4 Jar A16.68 during restoration  
with digital photo of partial jar  
(V14d4214, upside down)  
shown above as Illustr. 10:3



Photo V12d0908 O. Khalsa



Photo V12d1435 O. Khalsa

**Illustr. 10:5 Example of template (andiron A11.34)**

Arrows on the left indicate areas that were already cracked before dirt removal. The fissures became more apparent after the dirt was partially removed. They were consolidated during treatment. Arrows on the right indicate a corner of the arm of the andiron that was missing already when first excavated. Templates such as these are produced in the field and are immediately available for inspection.

- a Photo taken on July 7, 1999 before the start of the in-house excavation
- b Photo taken on July 11, 1999 at completion of the in-house excavation



**Illustr. 10:6** Work in the conservation laboratory on the andiron A11.34 comparing earlier stages of the process with the help of digital photography

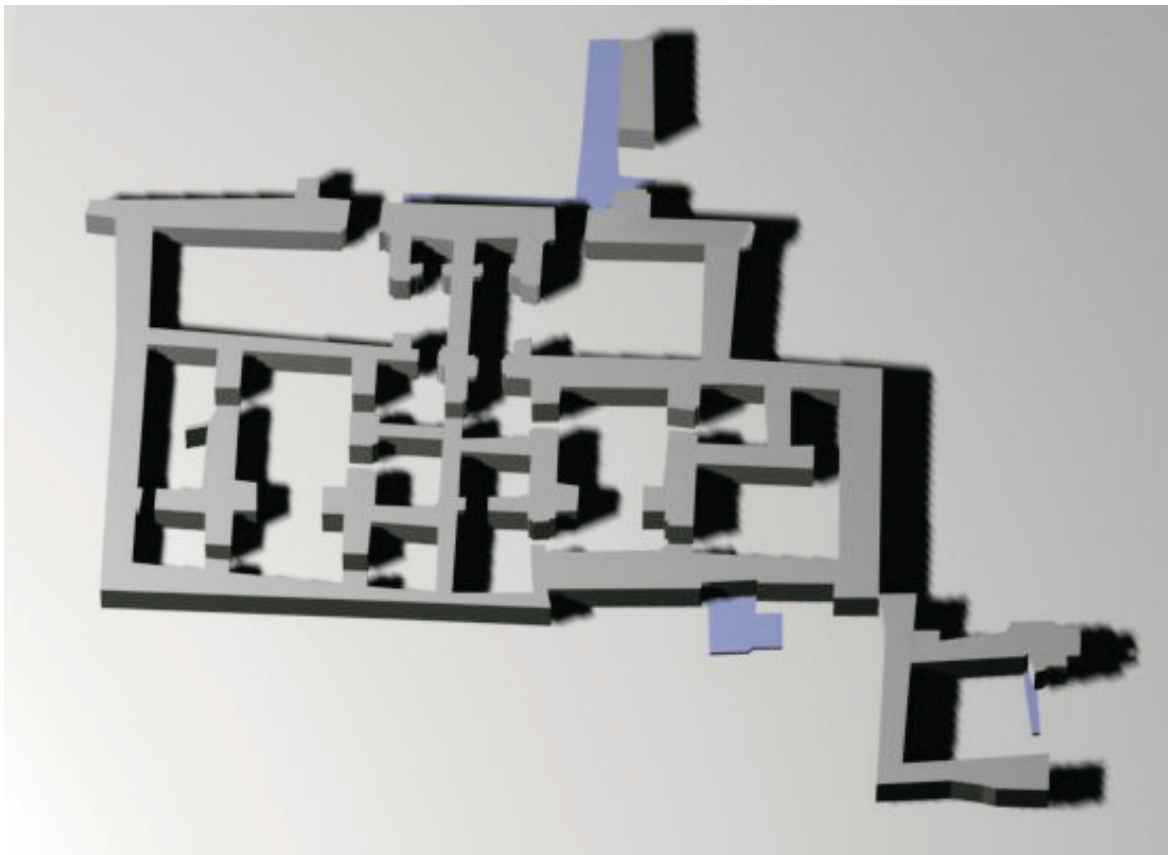
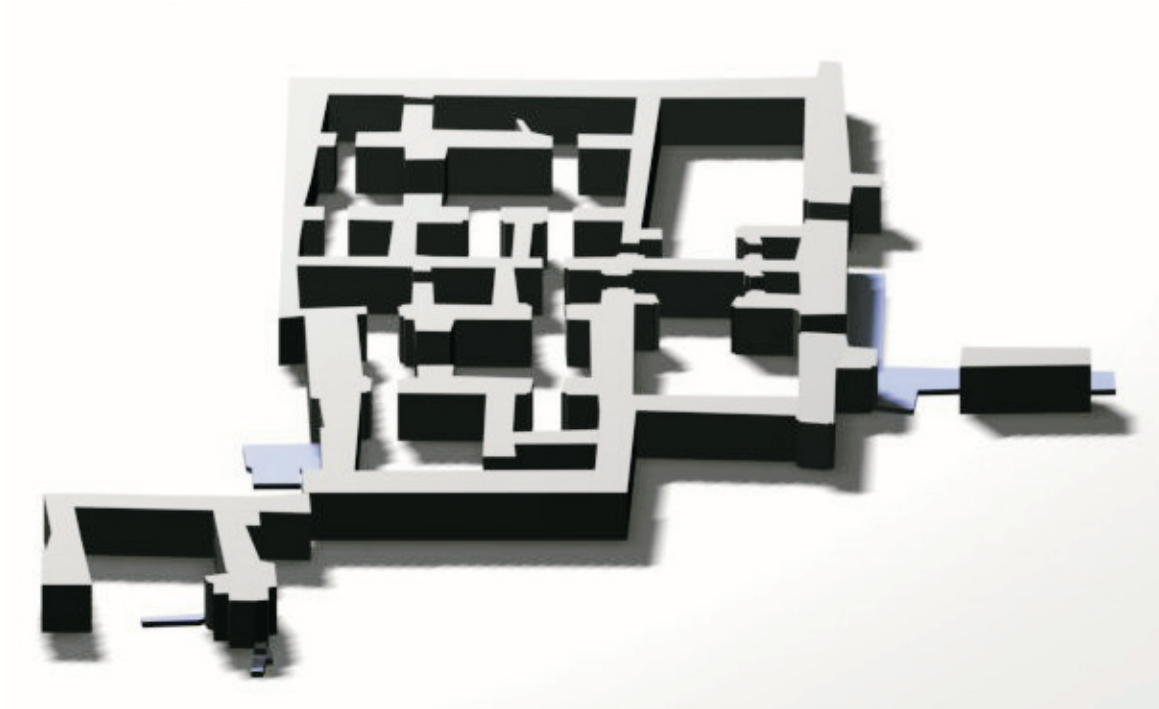

Illustr. 10:7 Two examples of digital modeling of the Royal Palace

- a Looking east, at a low angle with two sources of light
- b Looking north, at a higher angle, with one source of light